

# Mixed bag on the Green Belt front



**Robin Bishop** writes

THERE'S BOTH good and bad news regarding the Green Belt.

We've supported an application for Totteridge Academy's farm, which would appropriately re-purpose their meadow near the Dollis Brook. Because of the benefits for the education and wellbeing of both its students and the community, this is one of very exceptional circumstances that would permit building in the Green Belt. The few structures proposed rest lightly on the earth. It's also a chance to improve the land drainage of the adjoining public right of way, which is sometimes too waterlogged to walk on.

We're very concerned, however, about the proposed gas peaking station off Partingdale Lane. First, it would be built on that lovely tract of greenery that has miraculously survived between Totteridge and Mill Hill. Power generation is not one of the very exceptional circumstances explicitly permitted.

Secondly in view of our climate emergency, how can the loss of Green Belt vegetation – a benefit of which is carbon capture – be justified by burning fossil fuel? According to the proposer, no alternative sites are available and 'The contribution this development will make to the Government's objective nationally to securing a reliable source of low carbon electricity supply... constitutes very special circumstances'. We may not be able to challenge their energy case, but we will energetically object to the loss of Green Belt.

We still await a date for the Whalebones estate application for 152 homes go to Planning Committee, also for TfL/Taylor Wimpey's application for High Barnet Station. Other significant cases are summarised.



Visualisation of Academy farm by Assemble Design

## Approved

- Kingmaker House – 139 flats in former offices. (We opposed them).
- 2 Bruce Road – A house for multiple occupation. (We opposed it).
- 133 High Street – 5 flats above KFC.
- 164 High Street – 58 flats and houses plus affordable workspace on the Brake Shear House site.
- 37 Dury Road, Hadley – Replacement of a residential extension. (We supported it).
- Shell filling station, Stirling Corner – A welcome organic replacement for the present station, with half the petrol pumps replaced by electric charging points.

Londis. (We objected).

Meadow Works, Pricklers Hill – Replacement by 57 flats. (We opposed it, and the Planning Inspector agreed).

5G masts behind Barnet & Southgate College and by Whalebones field.

## Others worth noting

Old Courthouse Surgery, 27 Wood Street – Proposals to extend it have been withdrawn.

17 Park Road – After six unsuccessful attempts to get approval for micro-studios in this commercial building, a 7th application has been withdrawn.

## Refused

46-48 High Street – Roof extension above, and block behind, the former

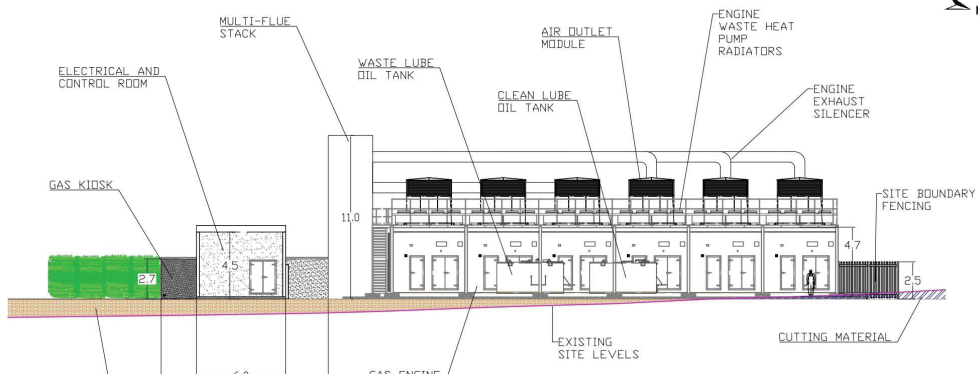

Elevation of gas plant by ESB & TNEI

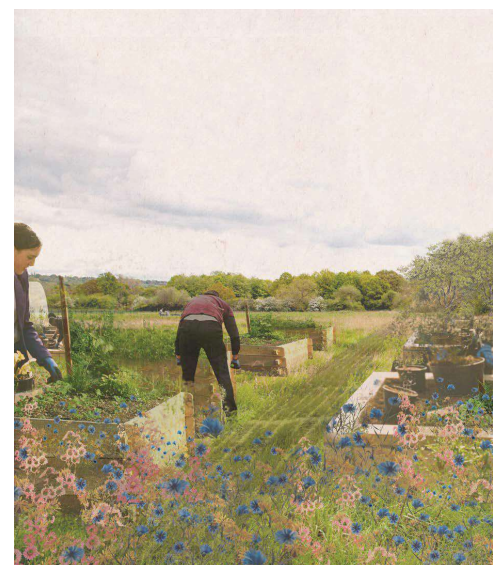

Students at work on the new farm